



American Kennel Club C-Course

Sunday, May 29, 2022

Judge: Debbie Pollard

Advanced | Intermediate | Started

AKC LICENSED HERDING

These elements will be used in any order. The elements used for C Course are:

- Freestanding Pen; Re-Pen; Narrow Road; Bridge; Traffic Road; Vehicle; Wide Graze; Narrow Graze; Placement before the Flock.
- Course Description and Diagrams are attached

Trials open to all AKC registered and ILP Dogs of the Herding Group

Trials held outside: Action K9 Sports, 15671 Old Milky Way, Escondido, CA 92027

Katherine Hammond, Trial Secretary, spvhctralsecretary@gmail.com

3950 Arroyo Sorrento Road, San Diego CA 92130

ENTRIES CLOSE: Monday, May 16th, 2022 at midnight

Certification: APPROVED by The American Kennel Club for the holding of this event under
American Kennel Club rules and regulations.
Gina M. DiNardo, Executive Secretary



CLUB OFFICERS

President: Terry Parrish, 15674 Old Milky Way, Escondido, CA 92027
Vice President: Barbara Easton, 1188 Hanson Way, Ramona CA 92065
Treasurer: Jamie Dixon, 936 Sunset Drive, Vista CA 92081
Secretary: Steve Kilgore, 778 Mountain View Place, El Cajon 92021
Board Member at Large: Reegan Ray, 734 San Dieguito Dr, Encinitas CA 92024

Chair Committee

Terry Parrish, Barbara Easton, Jamie Dixon, Steve Kilgore, Reegan Ray

Test & Trial Chair

Chair: Terry Parrish blazingbc@aol.com; (760) 739-8673

Livestock Manager: Blair Callicott, blairdc@gmail.com

Judging Assignments:

Deborah Pollard, Judge #ZC983 // Judging: C-Course
5212 ALLENDALE RD
VACAVILLE, CA 95688-9664
(530) 301-6610
herding4u@aol.com

Entries limited to 10 runs per day

One Trial - Sunday

Course C Sheep: Advanced | Intermediate | Started

Livestock

Sheep, Crossbred Approximate value \$250.00, 40 head for Trial Class runs

Awards *Awards presented after trial is over each day and winner MUST be present to receive award*

Offered by the San Pasqual Valley Herding Club

High in Trial: Course C, Sheep

Reserve High in Trial: Course C, Sheep

Trial Class

| | |
|------------------------|-----------------------|
| First Place | Blue Ribbon |
| Second Place | Red Ribbon |
| Third Place | Yellow Ribbon |
| Fourth Place | White Ribbon |
| Fifth Place | Pink Ribbon |
| Qualifying Trial Score | Dark Green Ribbon |
| New Title | Purple, Green Rosette |

High In Trial: Blue Red and Yellow Rosette and Herding Themed Item

Reserve High In Trial: Red Yellow and White Rosette and Herding Themed Item

Sponsorship

To sponsor trophies/awards contact: Steve Kilgore at skilgore111@gmail.com

HIGH IN TRIAL: \$30.00

RESERVE: \$25.00

General Ribbon Fund: \$20.00.

Donations to General fund is always appreciated.



ENTRY INFORMATION

ENTRIES CLOSE at Secretary's office at midnight, Monday, May 16th, 2022, after which time entries cannot be accepted or changed.

NOTE:

- Entry is not complete until payment transaction is complete.

ENTRY FEE INFORMATION

TRIAL ENTRY FEES:

- \$65.00 per entry, sheep.

ONLINE ENTRY

[Online Here](#)

Online forms email url is considered Signature

Paypal payment email is dedicatedtodogs@yahoo.com

Remember to include the CODB Fee of \$2.00 per entry per event. This is NON-REFUNDBALE

You may also complete the online entry and send a check to the Trial Secretary.

PAPER ENTRY

Paper Entries and Agreement can be printed and filled out, then mailed to: *Katherine Hammond Trial Secretary, 3950 Arroyo Sorrento Road, San Diego CA 92130*

Entry forms must be signed. Please check entry form before mailing to make sure it is legible and that all of the dog's titles are listed.

Entries sent via Express Mail must have the signature waived.

They can also be filled out, then emailed to:

spvhctralsecretary@gmail.com

PAPER ENTRY PAYMENT

Checks must be payable to: SPVHC, Inc

Mail Payment with Entry and Agreement to:

*Katherine Hammond Trial Secretary:
3950 Arroyo Sorrento Road, San Diego CA 92130*

OR send a Paypal payment to dedicatedtodogs@yahoo.com

REFUNDS

- You WILL NOT receive a refund if you scratch your entry AFTER the closing date or during the trialling period.
- You WILL receive a refund if you scratch your entry BEFORE the closing date.
- You WILL receive a refund if you are placed on the waitlist and do not compete.

AGREEMENT

I (we) acknowledge that the "Rules Applying to Registration and Dog Shows" and the "Rules for Herding Tests and Trials" have been made available to me (us) and that I (we) agree that the club holding this Herding Test or Trial has the right to refuse this entry for cause which the club shall deem to be sufficient. In consideration of the acceptance of this entry and of the holding of the Herding Test or Trial and of the opportunity to have the dog tested or judged and to win prize money, ribbons, or trophies, I (we) agree to hold this club, its' members, directors, governors, officers, agents, superintendents or show secretary and owner or lessor of the premises and any employees of the aforementioned parties harmless from any claim for loss or injury which may be alleged to have been caused directly or indirectly to any person or thing by the act of this dog while in or upon the Herding Test or Trial premises or grounds or near any entrance thereto, and I (we) personally assume all responsibility and liability for any such claim for damage or injury to the dog, whether such loss, disappearance, theft, damage or injury be caused or alleged to be caused by the negligence of the club or any of the parties aforementioned, or by the negligence of any other person, or any other causes.

I (we) hereby assume the sole responsibility for and agree to indemnify and save the aforementioned parties harmless from any and all loss and expense (including legal fees) by reason of the liability imposed by law upon any of the aforementioned parties for damage because of bodily injuries, including death at any time resulting there from, sustained by any person or persons, including myself (ourselves) or on account of damage to property, arising out of or in consequence of my (our) participation in the Herding Test or Trial, howsoever such injuries, death or damage to property may be caused, and whether or not the same may have been caused or may be alleged to have been caused by negligence of the aforementioned parties or any of their employees or agents, or any other persons.

I (we) will pay for any livestock injuries or replacement value in the event of death of any livestock by my (our) dog. In case of any injury to any stock caused by the dog entered, I (we) will assume total responsibility for any damage I (we) agree to pay the full market value of the injured animal in case of serious injury, or the veterinarian bill if the injury is slight.

I (WE) AGREE THAT ANY CAUSE OF ACTION, CONTROVERSY OR CLAIM ARISING OUT OF OR RELATED TO THE ENTRY, EXHIBITION OR ATTENDANCE AT THE EVENT BETWEEN THE AKC AND MYSELF (OURSELVES) OR AS TO THE CONSTRUCTION, INTERPRETATION AND EFFECT OF THIS AGREEMENT SHALL BE SETTLED BY ARBITRATION PURSUANT TO THE APPLICABLE RULES OF THE AMERICAN ARBITRATION ASSOCIATION. HOWEVER, PRIOR TO ARBITRATION ALL APPLICABLE AKC BYLAWS, RULES, REGULATIONS AND PROCEDURES MUST FIRST BE FOLLOWED AS SET FORTH IN THE AKC CHARTER AND BYLAWS, RULES, REGULATIONS, PUBLISHED POLICIES AND GUIDELINES.

Single copies of the latest editions of the "Rules Applying to Registration and Dog Shows", the "Obedience Regulations" and the "Regulations for Herding Tests and Trials" may be obtained WITHOUT CHARGE from the AMERICAN KENNEL CLUB, 5580 Centerview, Raleigh, NC 27606

Signature: _____

| |
|---|
| Official American Kennel Club Entry Form SPVHC |
| AKC Licensed Herding Tests & Trials |
| Action K 9 Sports Park, 15674 Old Milky Way, Escondido, CA |

Event # 2022700307

Entries close at midnight Monday, May 16th 2022

| | | | | |
|---|--------------------------|-----------|--------------|------|
| Debbie Pollard | Sunday, May 29 2022 | | | |
| | C Course Sheep | | | |
| | | | | |
| Course | \$65.00 | | | |
| Started | <input type="checkbox"/> | | | |
| Inter | <input type="checkbox"/> | | | |
| Adv | <input type="checkbox"/> | | | |
| Breed: | | DOB: | | Sex: |
| REGISTERED NAME OF DOG (AKC titles only): | | | | |
| Registration No: | | Call Name | | |
| Breeder: | | | | |
| Sire: | | | | |
| Dam: | | | | |
| Actual Owner(s): | | | | |
| Address: | | | | |
| City, State Zip | | | | |
| Handler (if not owner) | | | Fee enclosed | |
| PHONE: | | email: | | |

I CERTIFY that I am the actual owner of the dog, or that I am the duly authorized agent of the actual owner whose name I have entered above. In consideration of the acceptance of this entry I (we) agree to abide by the Rules and Regulations of the American Kennel Club in effect at the time of the Herding Test/Trial and by any additional rules and regulations appearing in the premium list for this Herding Test/Trial or both, and further agree to be bound by the "Agreement" printed on the reverse side of this entry form. I (we) certify and represent that the dog entered is not a hazard to persons or other dogs. This entry is submitted for acceptance on the foregoing representation and agreement.

SIGNATURE of owner or agent duly authorized to make this entry.

Date

Action K9 Sports Herding Events Disaster & Emergency Plan for People & Dogs

Cell and Landline phones available.

FIRE: Dial 911 All dogs should be crated or leashed securely and owners/handlers must make sure that they, their dogs and vehicles are out of driveways that Fire and Emergency vehicles would use for approach to the site of the fire. Escondido Fire Department responds at this site.

Forest Fire: All people and their secured dogs should immediately follow fire/emergency personnel evacuation directions and orders

Earthquake: Remain on the site with dogs secured. Use arenas for emergency animal housing if necessary. Use barn or house if safe. Wait for instructions via radio.

FOR ALL INJURIES:

First Aid Kit is at Trial Secretary's area

INJURY OR HEALTH PROBLEM WITH A PERSON:

If injury is immediately life-threatening-- **Dial 911** immediately for the emergency response team for the area. For serious, but not immediately life-threatening injury or illness **Dial 442-281-5000** to alert **Palomar Medical Center**, 2185 Citracado Parkway, Escondido, CA 92029. Proceed with victim to the hospital.

Driving Directions:

- Right on Old Milky Way.
- Right at stop sign onto Old San Pasqual.
- Left at light onto Hwy 78.
- Left at light on Valley Parkway.
- Go through downtown Escondido, past I-15. □ Right on Auto Park Way.
- Left at Citracado Parkway
- Palomar Medical Center on right.

INJURY TO DOG:

Alert the veterinarian on call **760-738-9600**. Owner and dog should proceed to:
Escondido Veterinary Urgent Care, 2525 S. Centre City Parkway, Escondido, CA 92025

Directions:

- Right onto Old Milky Way
- Right at stop sign onto Old San Pasqual
- Left at light onto 78
- Left onto 17th/Felicita
- Left at light onto S Escondido Blvd □ Left onto West Citracado Parkway
- Clinic on left.



Action K 9 Sports, 15671 Old Milky Way, Escondido, CA

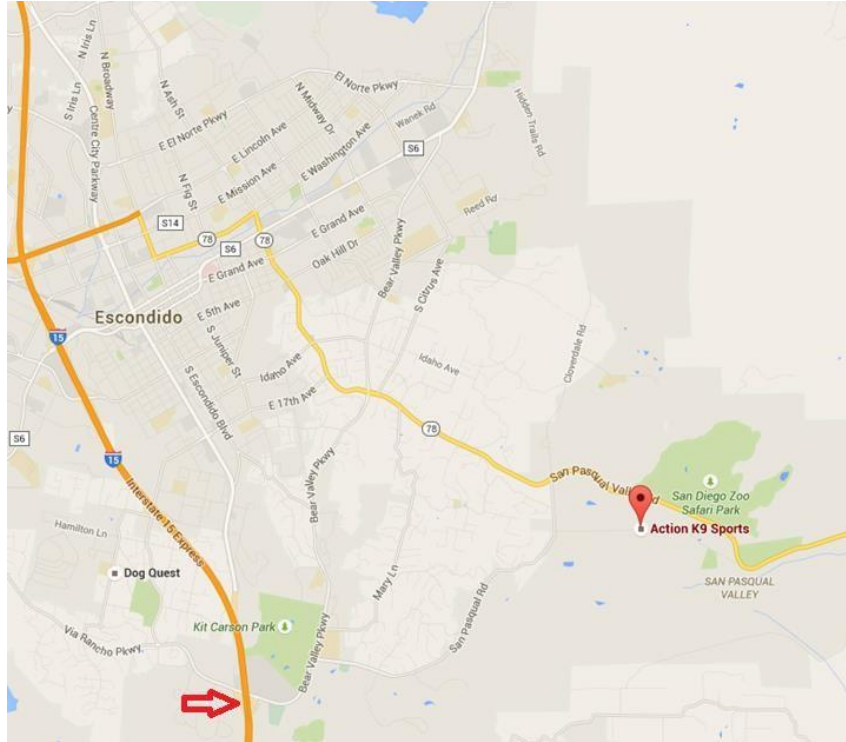

DIRECTIONS TO ACTION K9 SPORTS

FROM I-15

| | |
|---|--------------|
| Take exit 27/Via Rancho Parkway | |
| Go East onto W Via Rancho Pkwy | Go for 0.6 m |
| Continue on Bear Valley Pkwy S | Go for 0.3 m |
| Turn right onto San Pasqual Rd | Go for 2.9 m |
| Turn right onto Old Milky Way | Go for 1.6 m |
| Arrive at 15671 Old Milky Way turn Left into the dirt road for Action K9 Sports | |



Advanced level:

1. The pen: Open the gate and remove all sheep from the pen. Head uphill on the narrow road to the stop sign at the top of the hill.
2. Traffic stop: At the stop sign perform a traffic stop then proceed to the right on the farm road.
3. Traffic pass: After all sheep have entered the farm road the first car pass will approach from the front then pass from behind as the sheep are moving down the farm road to the wide graze. Stay left at the fork of the road and head to the open field.
4. Wide graze: Enter the left hand side of the field with the designated wide grazes. Turn right and continue along the leading edge of the field until reaching the assigned wide graze. Enter the wide graze.
5. Placement before the flock: At some point during the wide graze perform the placement before the stock.
6. After the wide graze has concluded, exit the wide graze and head left along the edge of the field to the narrow road.
7. Narrow road: Turn right on the narrow road and head back towards the ranch. Turn left at the traffic corner and head down hill towards the bridge.
8. The bridge: Turn left into the adjacent field and cross the bridge.
9. The narrow graze: After exiting the bridge head to the designated narrow graze. Move the sheep along the narrow graze and exit turning right to head back to the narrow road leading to the pen.
10. Reopen the sheep.

Intermediate level:

1. The pen: Open the gate and remove all sheep from the pen. Head uphill on the narrow road to the stop sign at the top of the hill.
2. Traffic stop: At the stop sign perform a traffic stop then proceed to the right on the farm road.
3. Traffic pass: After all sheep have entered the farm road the car pass will approach from the front as the sheep are moving down the farm road to the wide graze. Stay left at the fork of the road and head to the open field.
4. Wide graze: Enter the left hand side of the field with the designated wide grazes. Turn right and continue along the leading edge of the field until reaching the assigned wide graze. Enter the wide graze.
5. Placement before the flock: At some point during the wide graze perform the placement before the stock.
6. After the wide graze has concluded, exit the wide graze and head left along the edge of the field to the narrow road.
7. Narrow road: Turn right on the narrow road and head back towards the ranch. Turn left at the traffic corner and head down hill towards the bridge.
8. The bridge: Turn left into the adjacent field and cross the bridge. Turn right back to the narrow road leading to the pen.
9. Reopen the sheep.

Started level:

1. The pen: Open the gate and remove all sheep from the pen. Head uphill on the narrow road to the stop sign at the top of the hill.
2. Traffic stop: At the stop sign perform a traffic stop then proceed to the right on the farm road.
3. Traffic pass: Continue on the farm road heading to the open field. A vehicle will be parked on the road. Stay to the right of the vehicle on the way to the wide graze. Stay left at the fork of the road and head to the open field.
4. Wide graze: Enter the left hand side of the field with the designated wide grazes. Turn right and continue along the leading edge of the field until reaching the assigned wide graze. Enter the wide graze.
5. After the wide graze has concluded exit the field in the same direction as you entered heading back to the road leading back to the ranch. Turn left at the traffic stop and head down the hill to the bridge.
6. Bridge: Proceed across the bridge and turn right heading back to the pen.
7. Reopen the sheep.

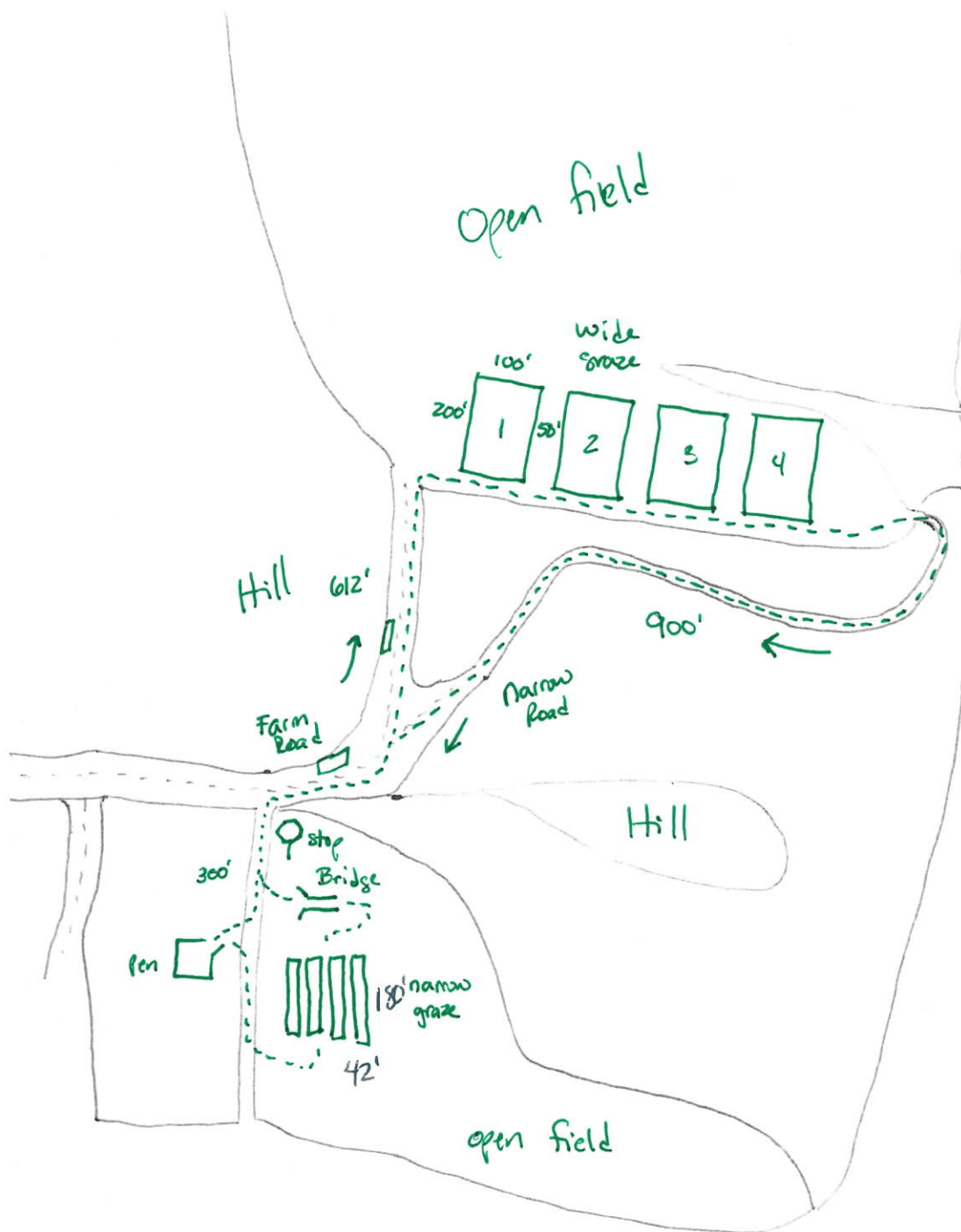

Advanced

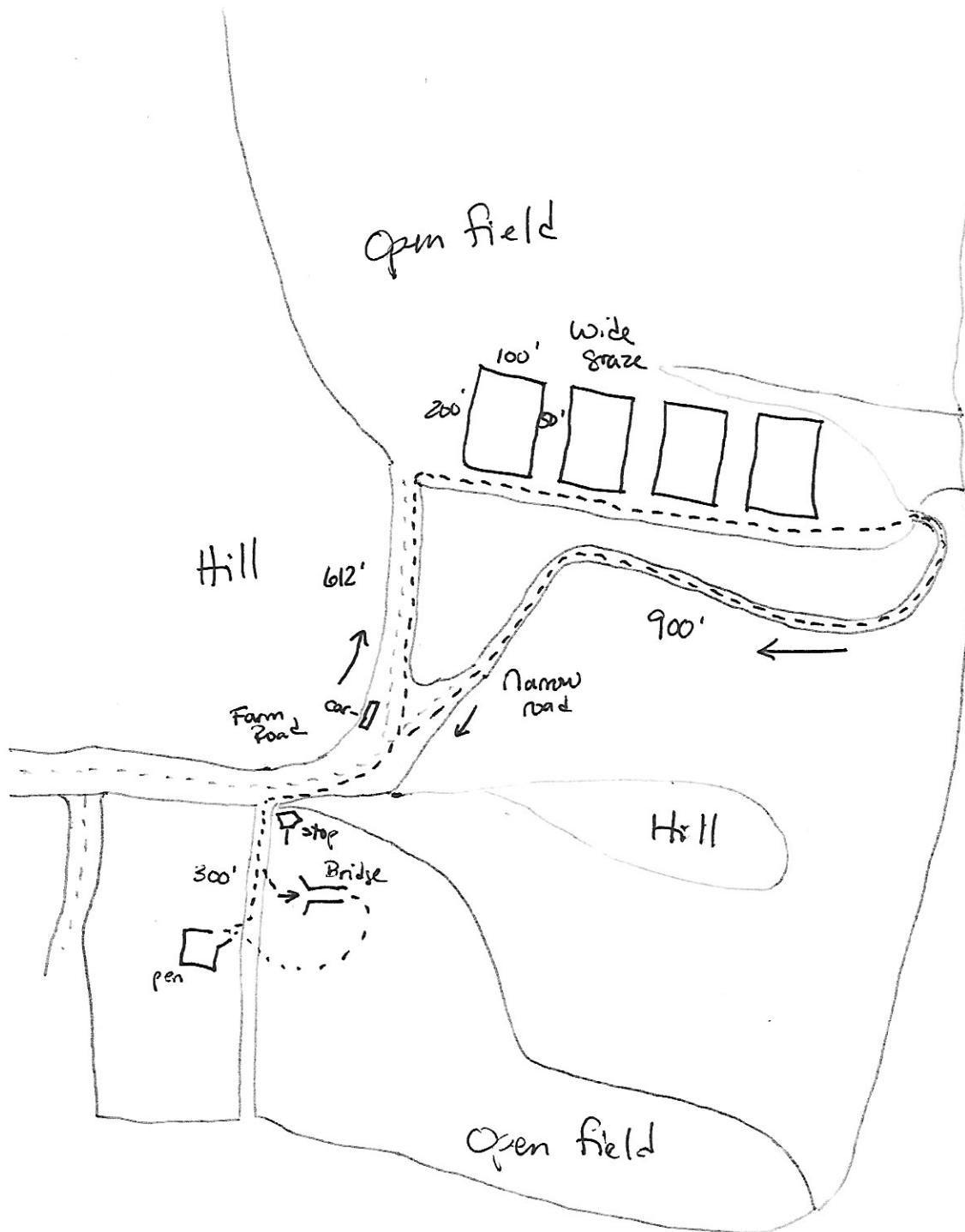

Intermediate

